

FUNCTION ROOMS

Le MERIDIEN

DIMENSIONS

FUNCTION ROOM	SIZES					SEATING					
	sqm	sqft	LENGTH	WIDTH	HEIGHT	THEATRE	CLASSROOM	ROUND TABLES	BOARDROOM	RECEPTION	U-SHAPE
Europasaal (Lyon, Mailand I+II)	217	2336	23,18	9,38	3,46	260	150	150	70	300	65
Lyon	127	1367	13,54	9,38	3,46	135	75	80	40	120	35
Lyon/Mailand II	157	1690	16,76	9,38	3,46	155	95	100	50	150	45
Mailand I	60	646	6,38	9,38	3,46	40	30	30	25	60	20
Mailand I + II	90	969	9,64	9,64	3,46	100	55	50	30	100	30
Birmingham I	53	570	5,62	9,38	2,24	30	20	20	20	40	15
Birmingham II	53	592	5,62	9,38	2,24	30	20	20	20	40	15
Birmingham I+II	108	1162	11,54	9,38	2,24	70	50	60	35	100	30
Goethe I	36	388	6,30	5,75	2,30	30	15	20	15	30	15
Goethe II	36	388	6,30	5,75	2,30	30	15	20	15	30	15
Stoltze	36	388	6,30	5,75	2,30	30	15	20	15	30	15
Goethe II + Stoltze	72	775	12,60	5,75	2,30	60	50	50	30	80	30
Goethe I + II + Stoltze	108	1162	18,90	5,75	2,30	90	60	80	40	100	30
Boardroom	30	323	6,70	4,50	2,30	-	-	-	12	-	-
Wiesenhüttensaal I	71	764	8,74	8,10	2,58	60	30	40	25	80	20
Wiesenhüttensaal II	62	667	7,62	8,10	2,58	60	30	40	25	80	20
Wiesenhüttensaal I + II	133	1432	16,38	8,10	2,58	120	70	80	40	160	40
Telepresence Room	43	463	11,94	6,20	2,60	-	-	-	8	-	-
La Truffe	70	753	12,70	5,55	3,80	45	25	-	35	80	15
Vinothek	34	366	5,28	6,42	3,80	25	-	-	12	40	12

GENERAL CONDITIONS:

- Prices given include seating and writing utensils.
- Room rents do not include accommodation.
- Conference equipment or items left in the rooms overnight must be insured by the event organiser.
- Attachment of items of any kind to walls or floors requires express permission. Event organisers (signatories) are liable for compensation in full for any damage caused.
- The Hotel reserves the right to charge an all-in price for storage and transport of delivered items, based on the volume and weight of the material to be transported.
- Changes to seating arrangements or major rearrangements on the event day will be invoiced on a time/effort basis.

FUNCTION ROOM	sqm	sqft	BUSINESS SEASON PREIS IN €
Europasaal (Lyon, Mailand I +II)	217	2336	2250
Lyon	127	1367	1250
Lyon/Mailand II	157	1690	1700
Mailand I	60	646	600
Mailand I + II	90	969	1050
Birmingham I	53	570	475
Birmingham II	55	592	475
Birmingham I+II	108	1162	950
Goethe I	36	388	300
Goethe II	36	388	300
Stoltze	36	388	300
Goethe II + Stoltze	72	775	600
Goethe I + II + Stoltze	108	1162	900
Boardroom	30	323	350
Wiesenhüttensaal I	71	764	550
Wiesenhüttensaal II	62	667	550
Wiesenhüttensaal I + II	133	1432	1100
Telepresence Room	43	463	on request
La Truffe	18	753	750
Vinothek	70	366	on request

FLOOR PLAN

- Ground floor
- 1st floor

GROUND FLOOR

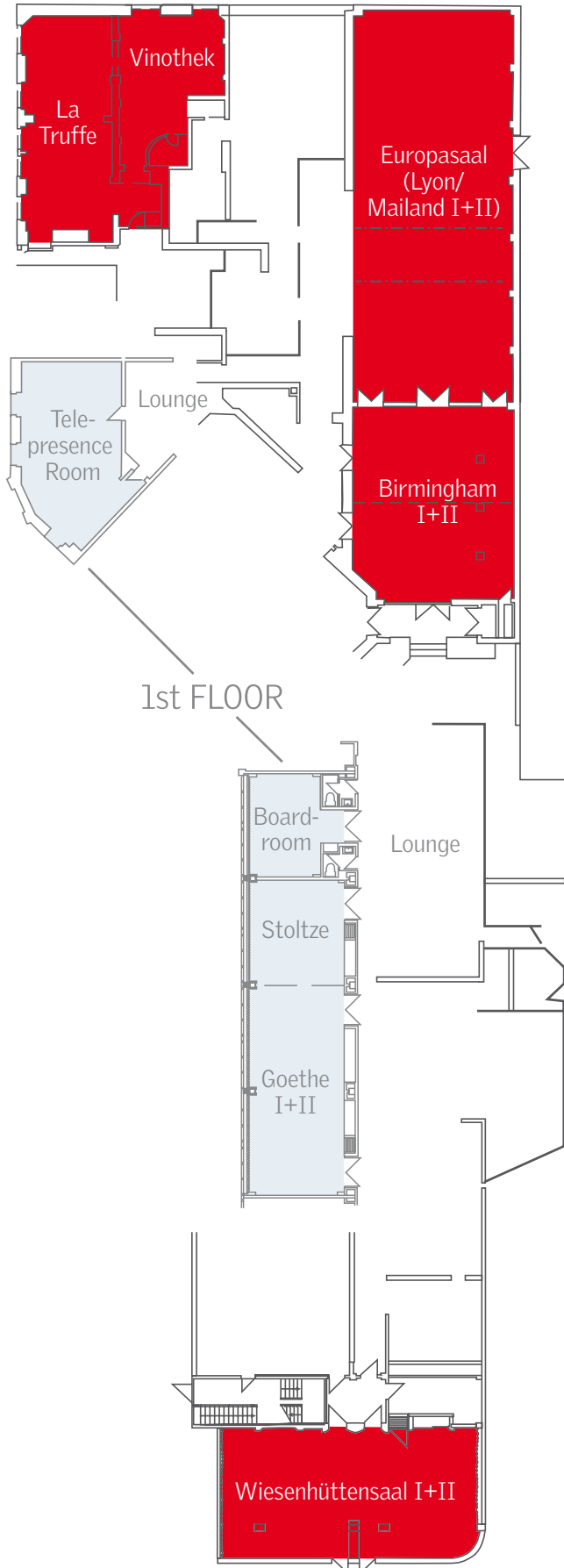

FUNCTION ROOMS
FLOOR PLAN

Le MERIDIEN



Le MERIDIEN

BANQUETTING SALES DEPARTMENT

For further information and group reservations:

T +49 69 2697 777

F +49 69 2697 812

banquet.parkhotel@lemeridien.com

LE MERIDIEN PARKHOTEL
FRANKFURT

WIESENHÜTTENPLATZ 28-38
60329 FRANKFURT, GERMANY

T +49 69 2697 0

F +49 69 2697 884

lemeridien.com/frankfurt